

House - Terraced

Millicent Road E10

£625,000

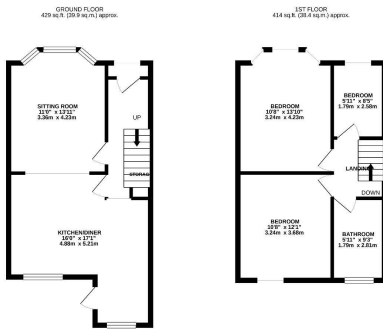

TOTAL FLOOR AREA: 843 sq ft (78.3 sq m) approx.

Viewings - Saturday 12th June - By Appointment Only

This is a beautiful end-of-terrace period property situated on a quiet residential street in Leyton.

This pretty Victorian house is ideal for young families as it is in the catchment for Riverley and Willowbrook Primary Schools, which are both rated 'Outstanding' by Ofsted. The extensive green spaces of Leyton Jubilee Park are a short stroll away. There are useful bus links at the end of the road and Lea Bridge Road Overground Station is a 10 minute walk; linking you directly to the city. Trendy Chatsworth Road in Clapton and the Lea River are also nearby, offering opportunities for weekend activities.

This extremely bright and spacious property has an impressive through sitting room / dining room with open access to the kitchen, making it ideal for family living. There is a generous ground floor living space and lots of natural light from the bay windows. The kitchen is fully fitted and practical, with lots of storage.

To the upstairs of the property there are two bright and airy double bedrooms with high ceilings and a bay window in the main bedroom. There is also a single room, ideal as a nursery or home office. The family sized bathroom is luxurious, light and sleek.

The garden gets lots of sun due to being end of terrace and is perfect for summer evenings. There is also a large lawn and a shed.

This property has the potential for a kitchen extension and a loft extension STPP. The immediate area is currently benefiting from some major redevelopment including the Council's East Valley plan which is set to improve the area over the next couple of years.



LINUS JACKSON
PROPERTY AGENT
LINUSJACKSON.CO.UK

020 8281 9699
55 MANOR ROAD, LONDON E10 7AL

LINUS JACKSON
PROPERTY AGENT
LINUSJACKSON.CO.UK

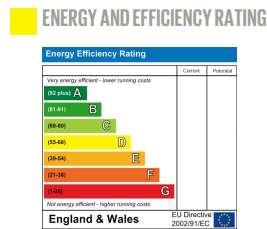

OUT AND ABOUT

Chatsworth Road - A short walk across Hackney marshes, Chatsworth Road has an abundance of cafes, pubs, restaurants and a fantastic Sunday market

Leyton Jubilee Park - Great facilities for sports and recreation and a natural meadow during the summer. Grab a coffee from the cafe or an ice lolly on a hot summers day.

Hare and Hounds - lovely pub with great burgers, live music, comedy and an all weather beer garden.

Turning Earth E10 - Artist led space running ceramics courses and studios for ceramicists.

Walthamstow Market - Europe's largest street market. The place to pick up a bargain!

Walthamstow Wetlands Nature Reserve - Area of protected wetlands, great for a walk and to visit the Engine House cafe.

